

PROMENADE LEVEL

CAPACITIES AND DIMENSIONS

MEETING ROOMS	SQ. FT.	WIDTH	LENGTH	CEILING	CLASSROOM	THEATER	RECEPTION	BANQUET
Roman Ballroom	11,087	93'9"	119'0"	16'6"	740	1200	950	740
Roman I	2,739	46'9"	58'7"	16'6"	180	300	240	180
Roman II	2,810	46'9"	60'1"	16'6"	180	300	240	180
Roman III	2,734	46'8"	58'7"	16'6"	180	300	240	180
Roman IV	2,805	46'8"	60'1"	16'6"	180	300	240	180
Florentine Ballroom	7,349	61'8"	121'6"	16'6"	480	740	600	480
Florentine I	1,855	30'3"	61'8"	16'6"	120	185	150	120
Florentine II	1,829	29'8"	61'8"	16'6"	120	185	150	120
Florentine III	1,829	29'8"	61'8"	16'6"	120	185	150	120
Florentine IV	1,835	29'9"	61'8"	16'6"	120	185	150	120
Neopolitan Ballroom	6,597	42'0"	157'1"	16'6"	440	660	600	440
Neopolitan I	2,058	42'0"	49'0"	16'6"	140	210	190	140
Neopolitan II	1,533	42'0"	36'6"	16'6"	100	150	140	100
Neopolitan III	1,533	42'0"	36'6"	16'6"	100	150	140	100
Neopolitan IV	1,473	42'0"	35'1"	16'6"	100	150	140	100
Pompeian Ballroom	5,467	45'7"	121'6"	16'6"	360	600	400	360
Pompeian I	1,353	30'4"	45'7"	16'6"	90	135	100	90
Pompeian II	1,398	30'8"	45'7"	16'6"	90	140	100	90
Pompeian III	1,397	30'7"	45'8"	16'6"	90	140	100	90
Pompeian IV	1,320	28'11"	45'8"	16'6"	90	135	100	90
Anzio	932	26'0"	36'4"	15'6"	55	90	75	60
Capri	1,266	28'8"	44'9"	16'6"	80	120	100	80
Bacchus	684	25'6"	38'	9'4"	14	42	20	20
Consul Boardroom	993	23'2"	43'3"	17'0"	16	—	—	16
Genoa	659	21'10"	32'10"	13'0"	45	75	60	45
Imperial Boardroom	838	23'6"	35'8"	17'0"	16	—	—	16
Sorrento	949	28'0"	33'11"	13'9"	60	95	85	60

MEETING ROOMS	SQ. FT.	WIDTH	LENGTH	CEILING	CLASSROOM	THEATER	RECEPTION	BANQUET
Messina	1,160	27'2"	44'6"	15'6"	55	100	80	60
Livorno	751	27'4"	28'2"	16'6"	45	75	60	50
Modena	714	23'9"	30'11"	13'0"	50	85	70	40
Palermo	819	28'5"	30'5"	12'6"	55	70	50	40
Pisa	1,244	26'5"	47'7"	12'6"	85	125	100	80
Salerno	1,024	28'0"	36'7"	13'9"	70	100	90	70
Senate Boardroom	1,142	25'1"	44'7"	17'0"	16	—	—	16
Siena	690	30'0"	23'0"	12'6"	48	72	65	40
Naples	404	15'	28'9"	9'9"	18	21	16	20
Trevi	1,261	32'6"	38'10"	13'9"	85	125	100	60
Turin	1,248	32'0"	39'0"	13'9"	85	125	100	60
Verona	1,258	32'3"	39'0"	13'9"	85	125	100	60

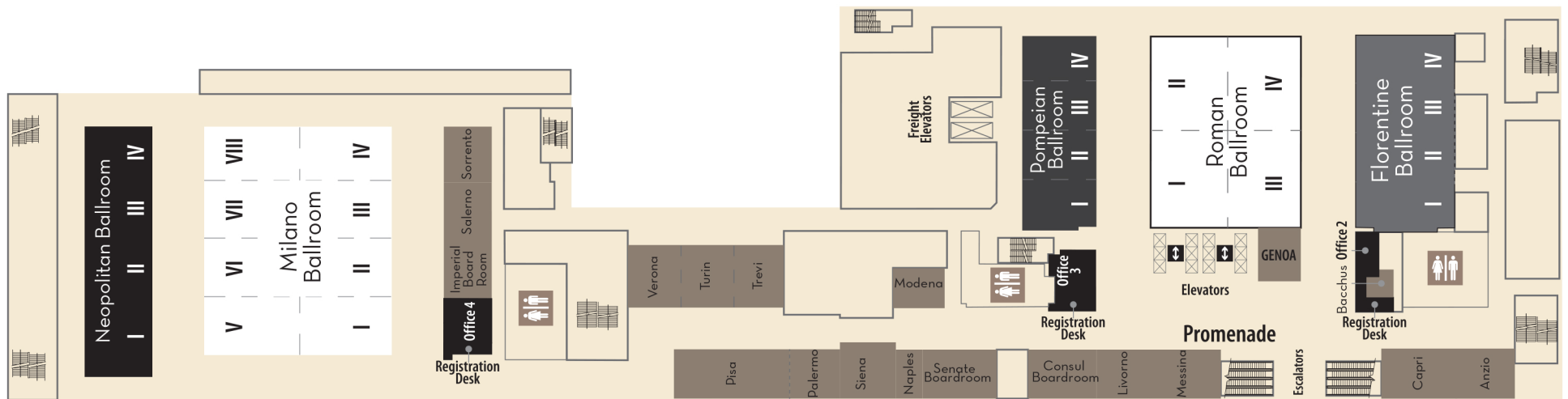

EMPERORS LEVEL

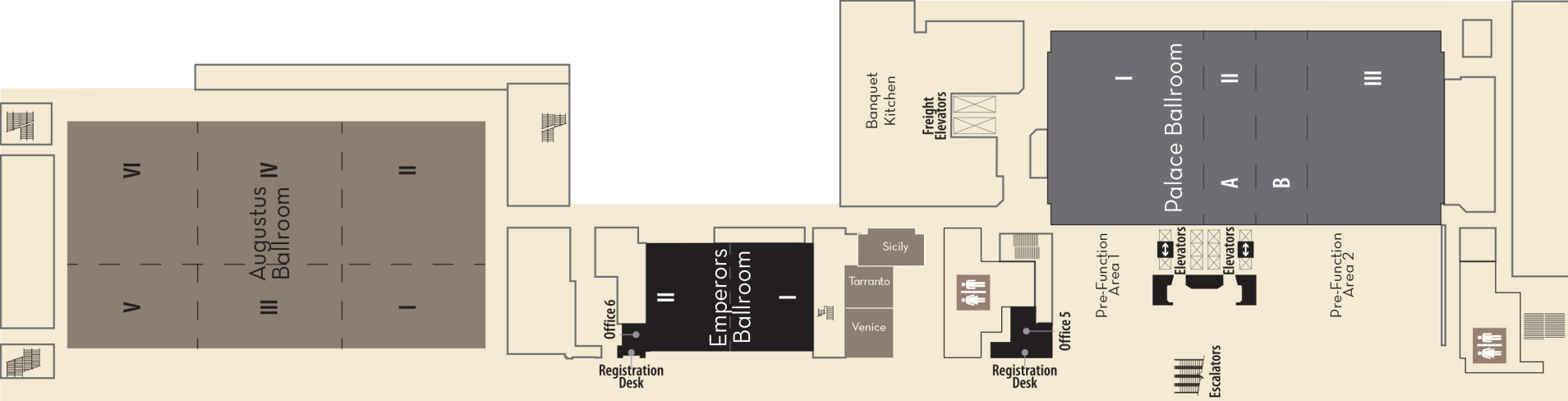

CAPACITIES AND DIMENSIONS

ROOM	SQ. FT.	WIDTH	LENGTH	CEILING	CLASSROOM	THEATER	RECEPTION	BANQUET
Augustus Ballroom	36,260	259'0"	140'0"	20'8"	2,420	3,630	3,300	2,420
Augustus I	4,390	89'0"	49'4"	20'8"	290	440	400	290
Augustus II	8,069	89'0"	90'8"	20'8"	540	810	730	540
Augustus III	4,440	90'0"	49'4"	20'8"	290	440	400	290
Augustus IV	8,160	90'0"	90'8"	20'8"	540	810	730	540
Augustus V	3,946	80'0"	49'4"	20'8"	260	400	360	260
Augustus VI	7,253	80'0"	90'8"	20'8"	480	720	660	480
Palace Ballroom	28,592	119'10"	243'6"	20'8"	2,000	3,200	2,600	2,000
Palace I	11,474	97'1"	119'10"	20'8"	800	1,300	1,050	800
Palace II	7,579	63'7"	119'10"	20'8"	500	700	600	500
Palace III	9,539	82'2"	119'10"	20'8"	700	1,200	950	700
Palace I / IIA	15,232	128'9"	119'10"	20'8"	1,050	1,650	1,350	1,050
Palace IIB / III	13,566	114'1"	119'10"	20'8"	950	1,550	1,250	950
Palace Pre-Function 1	2,994	52'0"	62'7"	18'4"	—	—	350	—
Palace Pre-Function 2	8,368	76'4"	117'6"	18'4"	—	—	1,000	—
Emperors Ballroom	6,247	61'7"	102'9"	16'0"	400	625	500	400
Emperors I	3,153	51'2"	61'7"	16'0"	200	315	250	200
Emperors II	3,126	51'3"	61'7"	16'0"	200	315	250	200
Venice	805	28'0"	28'9"	14'0"	40	60	45	40
Tarranto	792	27'6"	28'10"	13'0"	45	60	45	40
Sicily	923	22'10"	40'7"	14'0"	60	80	65	50

PROMENADE SOUTH

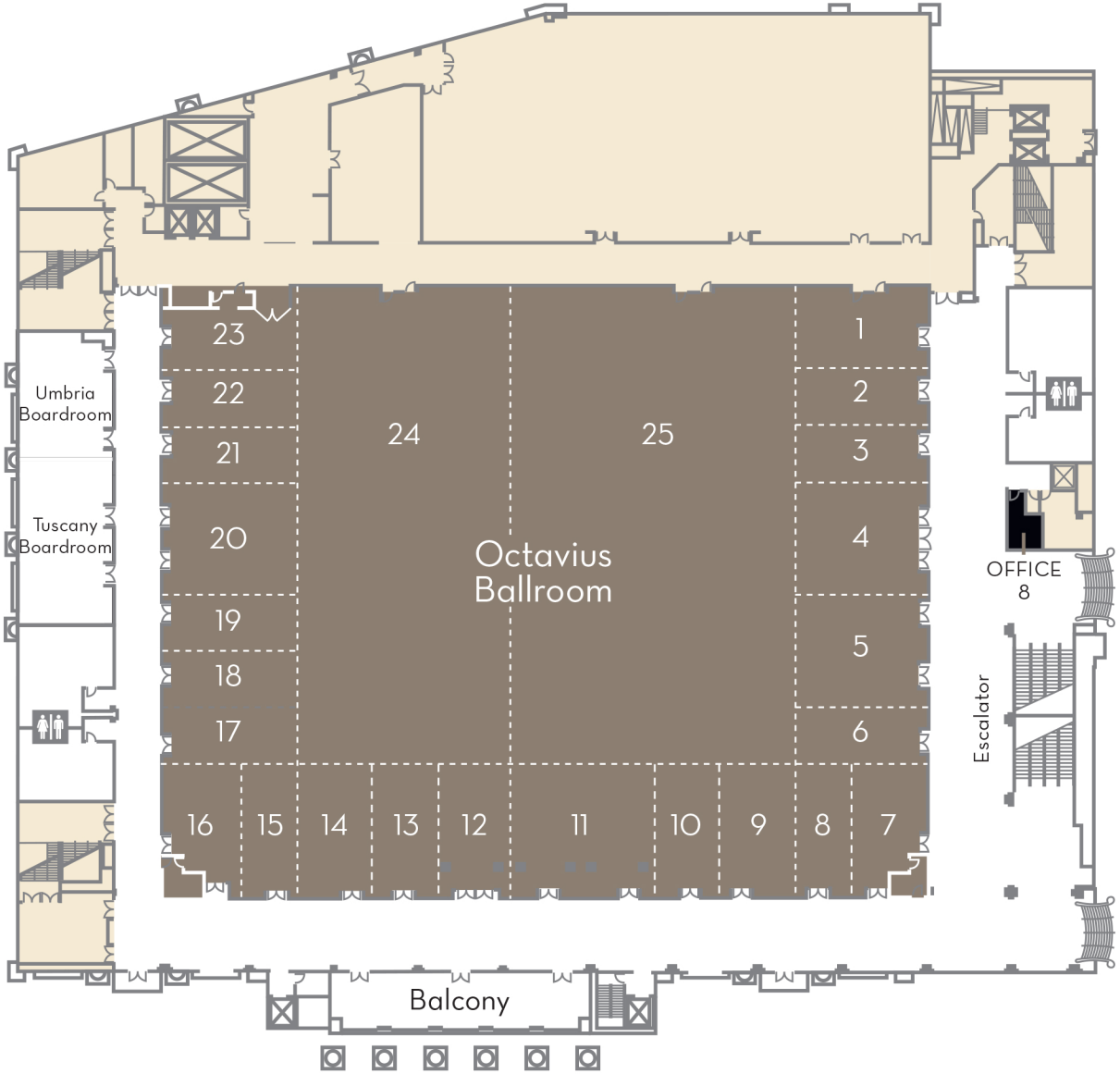

CAPACITIES AND DIMENSIONS

ROOM	SQ. FT.	WIDTH	LENGTH	CEILING	CLASSROOM	THEATER	RECEPTION	BANQUET
Milano Ballroom	16,874	118'0"	143'0"	16'6"	1,120	1,690	1,530	1,120
Milano I	2,079	59'0"	35'3"	16'6"	140	210	190	140
Milano II	2,153	59'0"	36'6"	16'6"	140	210	190	140
Milano III	2,153	59'0"	36'6"	16'6"	140	210	190	140
Milano IV	2,069	59'0"	35'1"	16'6"	140	210	190	140
Milano V	2,079	59'0"	35'3"	16'6"	140	210	190	140
Milano VI	2,153	59'0"	36'6"	16'6"	140	210	190	140
Milano VII	2,153	59'0"	36'6"	16'6"	140	210	190	140
Milano VIII	2,069	59'0"	35'1"	16'6"	140	210	190	140
Octavius Ballroom	50,944	256	199	26'	3,450	5,555	5,260	4,160
Octavius 1	840	21	40	26'	54	85	90	60
Octavius 2	800	20	40	26'	54	90	85	60
Octavius 3	800	20	40	26'	54	90	85	60
Octavius 4	1,600	40	40	26'	108	180	170	130
Octavius 5	1,600	40	40	26'	108	180	170	130
Octavius 6	800	20	40	26'	54	90	85	60
Octavius 7	760	20	38	26'	51	85	80	60
Octavius 8	722	19	38	26'	48	75	75	50
Octavius 9	988	26	38	26'	66	105	100	70
Octavius 10	874	23	38	26'	57	95	90	70
Octavius 11	1,938	51	38	26'	129	210	200	150
Octavius 12	950	25	38	26'	66	105	100	70
Octavius 13	874	23	38	26'	57	95	90	70
Octavius 14	988	26	38	26'	66	105	100	70
Octavius 15	722	19	38	26'	48	75	75	50
Octavius 16	760	20	38	26'	51	85	80	60
Octavius 17	800	20	40	26'	54	90	85	60
Octavius 18	800	20	40	26'	54	90	85	60
Octavius 19	800	20	40	26'	54	90	85	60
Octavius 20	1,600	40	40	26'	108	180	170	130
Octavius 21	800	20	40	26'	60	90	85	60
Octavius 22	800	20	40	26'	60	90	85	60
Octavius 23	840	21	40	26'	57	95	90	60
Octavius 24	12,075	75	161	26'	828	1,335	1,260	1,000
Octavius 25	16,261	101	161	26'	1,101	1,775	1,700	1,330
Umbria Boardroom	1,179	41'1"	27'6"	26'	16	—	—	16
Tuscany Boardroom	1,569	54'4"	27'6"	26'	16	—	—	16

CAPACITIES AND DIMENSIONS

ROOM	SQ. FT.	WIDTH	LENGTH	CEILING	CLASSROOM	THEATER	RECEPTION	BANQUET
Julius Ballroom	50,944	256	199	22'2"	3,450	5,555	5,260	4,160
Julius 1	840	21	40	22'2"	54	85	90	60
Julius 2	800	20	40	22'2"	54	90	85	60
Julius 3	800	20	40	22'2"	54	90	85	60
Julius 4	1,600	40	40	22'2"	108	180	170	130
Julius 5	1,600	40	40	22'2"	108	180	170	130
Julius 6	800	20	40	22'2"	54	90	85	60
Julius 7	760	20	38	22'2"	51	85	80	60
Julius 8	722	19	38	22'2"	48	75	75	50
Julius 9	988	26	38	22'2"	66	105	100	70
Julius 10	874	23	38	22'2"	57	95	90	70
Julius 11	1,938	51	38	22'2"	129	210	200	150
Julius 12	950	25	38	22'2"	66	105	100	70
Julius 13	874	23	38	22'2"	57	95	90	70
Julius 14	988	26	38	22'2"	66	105	100	70
Julius 15	722	19	38	22'2"	48	75	75	50
Julius 16	760	20	38	22'2"	51	85	80	60
Julius 17	800	20	40	22'2"	54	90	85	60
Julius 18	800	20	40	22'2"	54	90	85	60
Julius 19	800	20	40	22'2"	54	90	85	60
Julius 20	1,600	40	40	22'2"	108	180	170	130
Julius 21	800	20	40	22'2"	60	90	85	60
Julius 22	800	20	40	22'2"	60	90	85	60
Julius 23	840	21	40	22'2"	57	95	90	60
Julius 24	12,075	75	161	22'2"	828	1,335	1,260	1,000
Julius 25	16,261	101	161	22'2"	1,101	1,775	1,700	1,330
Abruzzi	819	29'	27'	17'	51	80	60	60
Calabria	891	29'	27'	17'	51	80	60	60
Campania Boardroom	1,179	42'	28'	17'	16	—	—	16
Patrician	588	28'	21'	17'	36	60	50	40
Tribune	734	27'	27'	17'	48	75	50	50